

ELARA HIGH GLOSS 2 DRAWER ENTERTAINMENT UNIT

ITEM CODE: 7325-2-01/02

45 MINS

APPROXIMATE ASSEMBLY TIME

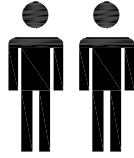

2 PERSON ASSEMBLY

FLOOR AREA
3.5M X 1.5M

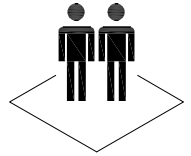

REQUIRED ASSEMBLY SPACE

REQUIRED ASSEMBLY TOOLS

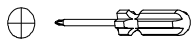

POZI SCREWDRIVER

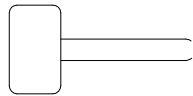

HAMMER

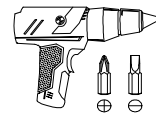

DRILL

ASSEMBLED DIMENSIONS

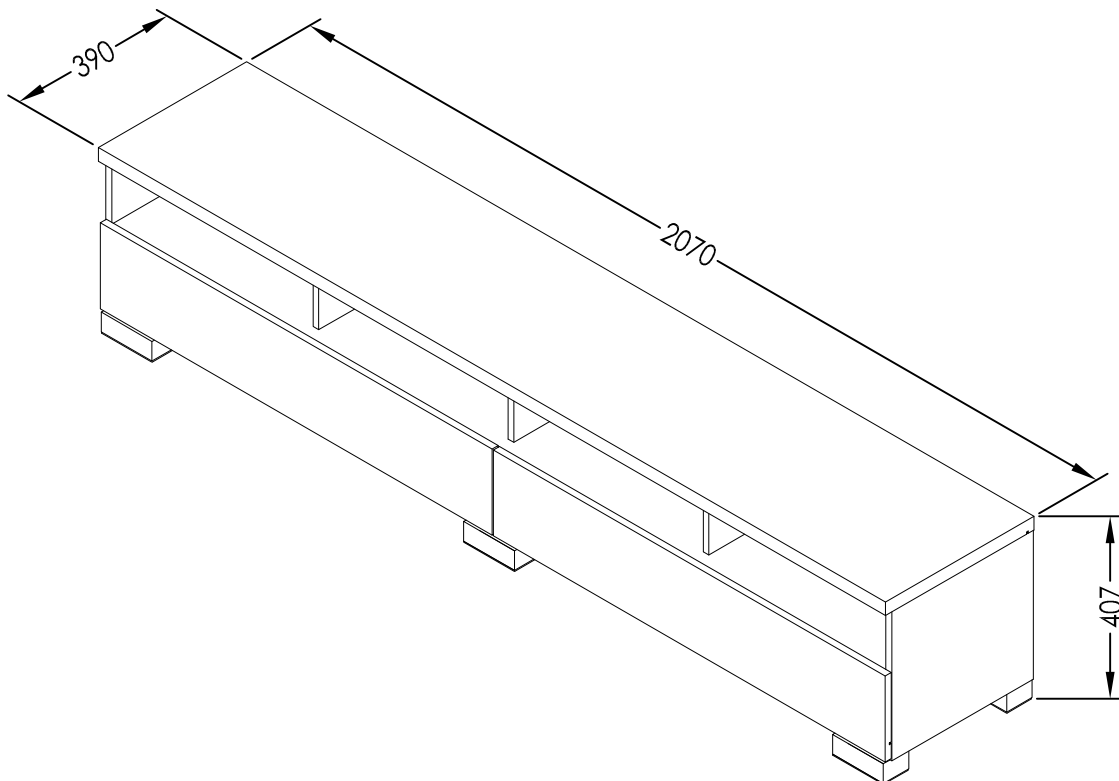

ELARA HIGH GLOSS 2 DRAWER ENTERTAINMENT UNIT

ITEM CODE: 7325-2-01/02

Tips before you start:

1. Please check that all parts are present before you start the assembly of your furniture.
2. For ease and speed of assembly, we recommend that before you commence each step of the assembly, that you identify all the parts required for that step.
3. For larger items, please ensure that you have sufficient space and people (as indicated on page 1) to assemble your product safely.
4. We recommend that, where possible, all items are assembled near to the area in which they will be placed in use, to avoid moving the product unnecessarily once assembled.
5. For the protection of your furniture, we recommend that the product is placed on a protected surface during assembly to prevent any damage.
6. During assembly please take care not to over-tighten any fittings, as this may damage the product.
7. Always place the product on a flat, steady and stable surface.
8. Do not stand on the product. Do not use the product as a stepladder.
9. This product is intended for indoor, household use only as it is non industrial product.

Care and Maintenance of your Furniture

- ☒ Please periodically check all fittings and re-tighten as necessary.
- ☒ To clean your item, please use a damp cloth and wipe clean.
- ☒ Never allow any kind of liquid to remain on your furniture. Absorption can cause wood to warp or finishes to de-laminate.
- ☒ Please do not place hot item (e.g. hot drinks) directly on to the wood surface.
- ☒ Please do not drag or pull your furniture.

ELARA HIGH GLOSS 2 DRAWER ENTERTAINMENT UNIT

ITEM CODE: 7325-2-01/02

Tips before you start:

QUICKFIT

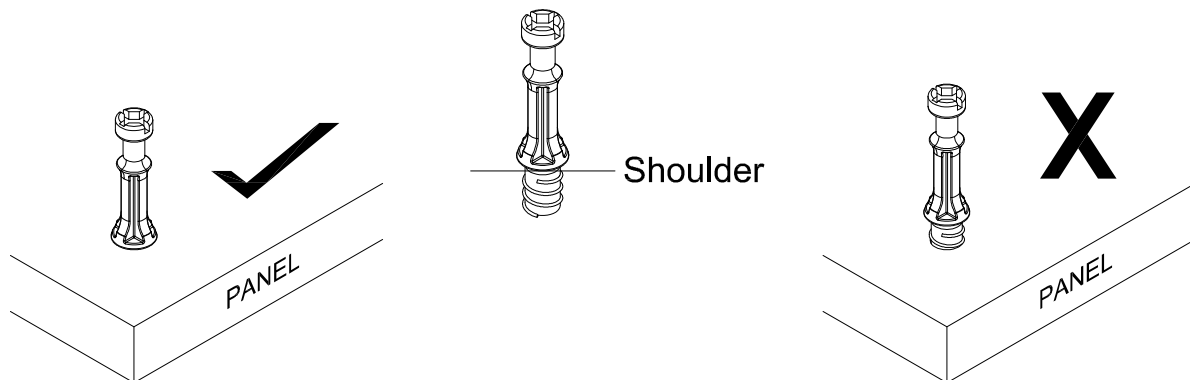

Tighten quickfit until shoulder is flush with panel. Do not overtighten or undertighten.

CAM LOCK

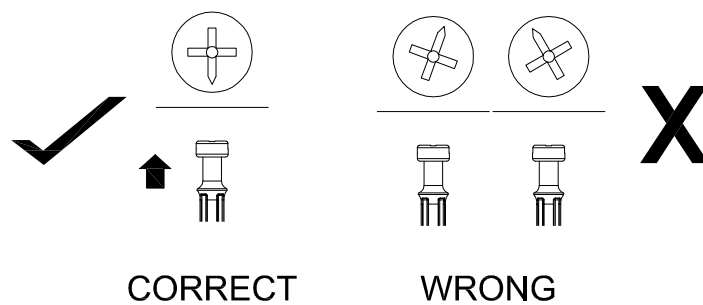

When fitting cam lock, ensure starting position is correct before you insert connecting quickfit.

Quickfit head should be in the centre of the cam lock when the two panels are joined.

Cam lock should be inserted before quickfit.

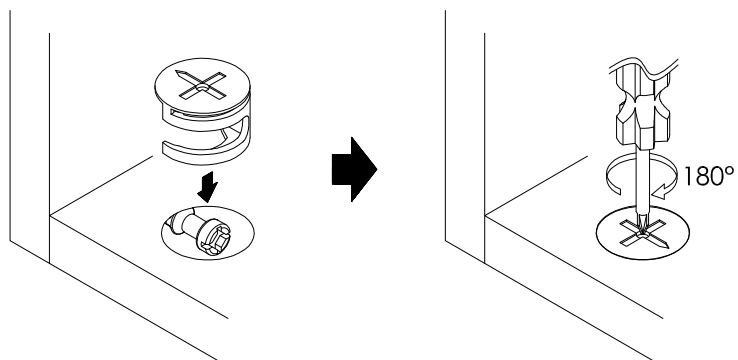

Turn camlock clockwise to tighten.

ELARA HIGH GLOSS 2 DRAWER ENTERTAINMENT UNIT

ITEM CODE: 7325-2-01/02

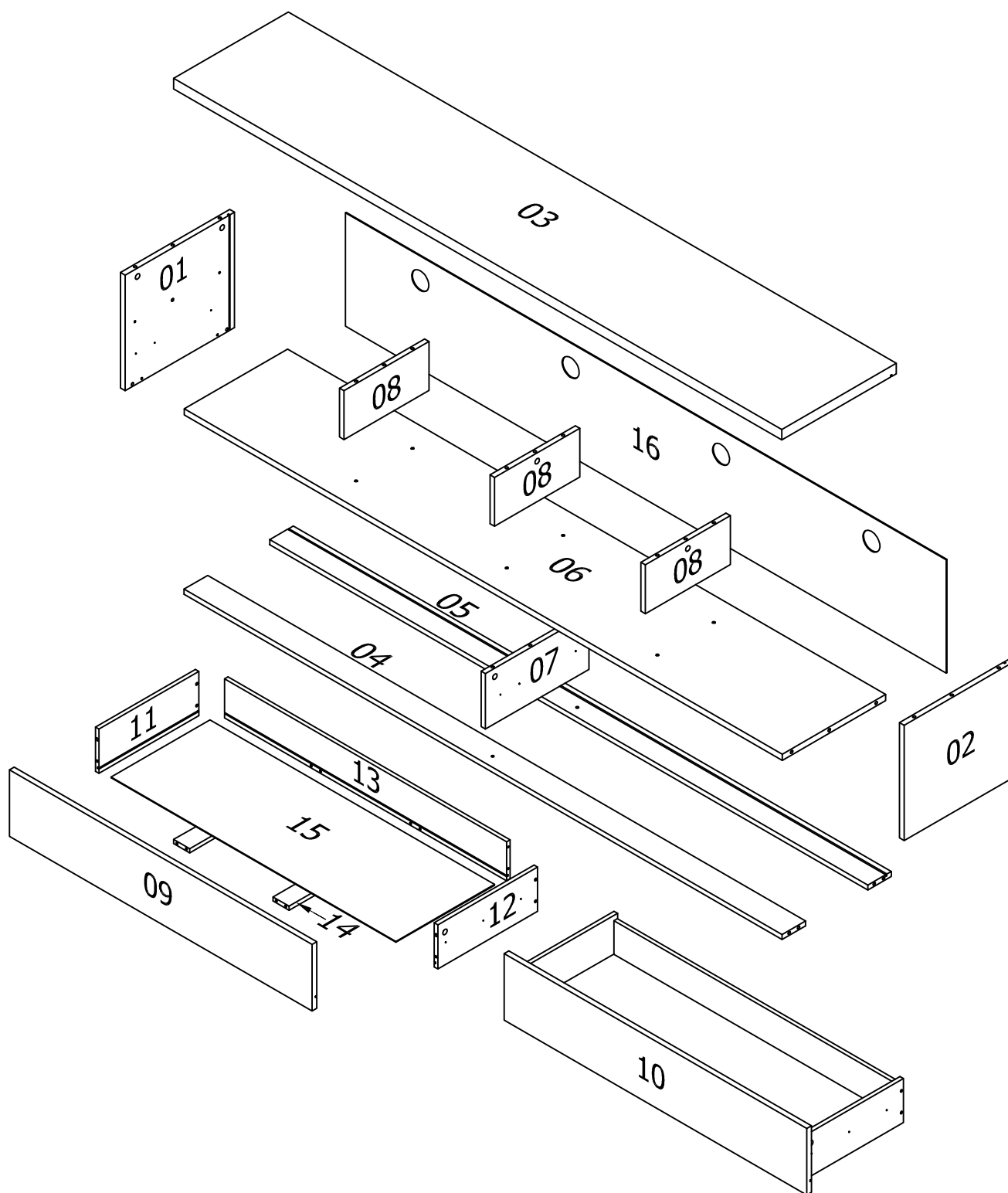

ELARA HIGH GLOSS 2 DRAWER ENTERTAINMENT UNIT

ITEM CODE: 7325-2-01/02

PART LIST:

NO.	PART NAME	QTY
1	SIDE PANEL (LEFT)	1
2	SIDE PANEL (RIGHT)	1
3	TOP PANEL	1
4	BOTTOM PANEL (FRONT)	1
5	BOTTOM PANEL (BACK)	1
6	CENTER PANEL	1
7	SUPPORT PANEL (CENTER)	1
8	DIVIDER PANEL	3

NO.	PART NAME	QTY
9	DRAWER FRONT (LEFT)	1
10	DRAWER FRONT (RIGHT)	1
11	DRAWER SIDE (LEFT)	2
12	DRAWER SIDE (RIGHT)	2
13	DRAWER BACK	2
14	DRAWER SUPPORT	4
15	DRAWER BOTTOM	2
16	BACK PANEL	1

ELARA HIGH GLOSS 2 DRAWER ENTERTAINMENT UNIT

ITEM CODE: 7325-2-01/02

HARDWARE LIST

(A) X14



CSK SCREW
M3.5 X 15MM

(B) X24



CSK SCREW
M3.5 X 12MM

(C) X16

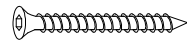

JCBC(W) SCREW
M6 X 40MM

(D) X20



WOOD DOWEL
Ø6 X 20MM

(E) X15



WOOD DOWEL
Ø8 X 25MM

(F) X21



BOLT-9607 PARALEL
NECK DOWEL 24 X 8.5

(G) X17



CAM-9499 CAM
3000 15/12MM

(H) X4



CAM-9642 CAM
3000 12/13MM

(Z1) X4



METAL DRAWER GLIDE W/STOPPER
(350MM) - 3 EXTENTION

(Z2) X4

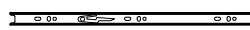

(J) X6

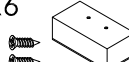

RECTANGLE LEG (H 6MM)=(1 PC) WITH
SCREW (M3.5 X 15MM)=(2 PCS)

(K) X7



PLASTIC CAM CAP
(Ø17MM)

(L) X1



ALLEN KEY M4

(M) X14



BACKPLY STOPPER

(N) X3

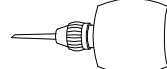

GLUE

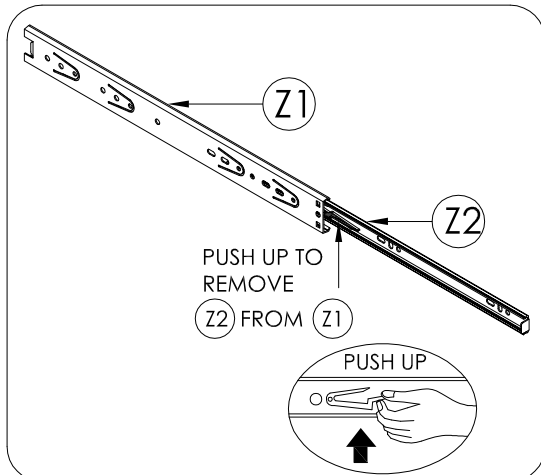

Z1 & Z2

ELARA HIGH GLOSS 2 DRAWER ENTERTAINMENT UNIT

ITEM CODE: 7325-2-01/02

STEP 1

Using glue (N) insert dowel (D & E) into pieces (1, 2, 4, 5, 6, 7, 8, 11, 12 & 14) as shown.

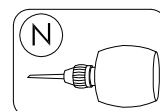
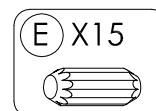
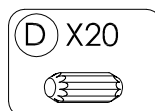
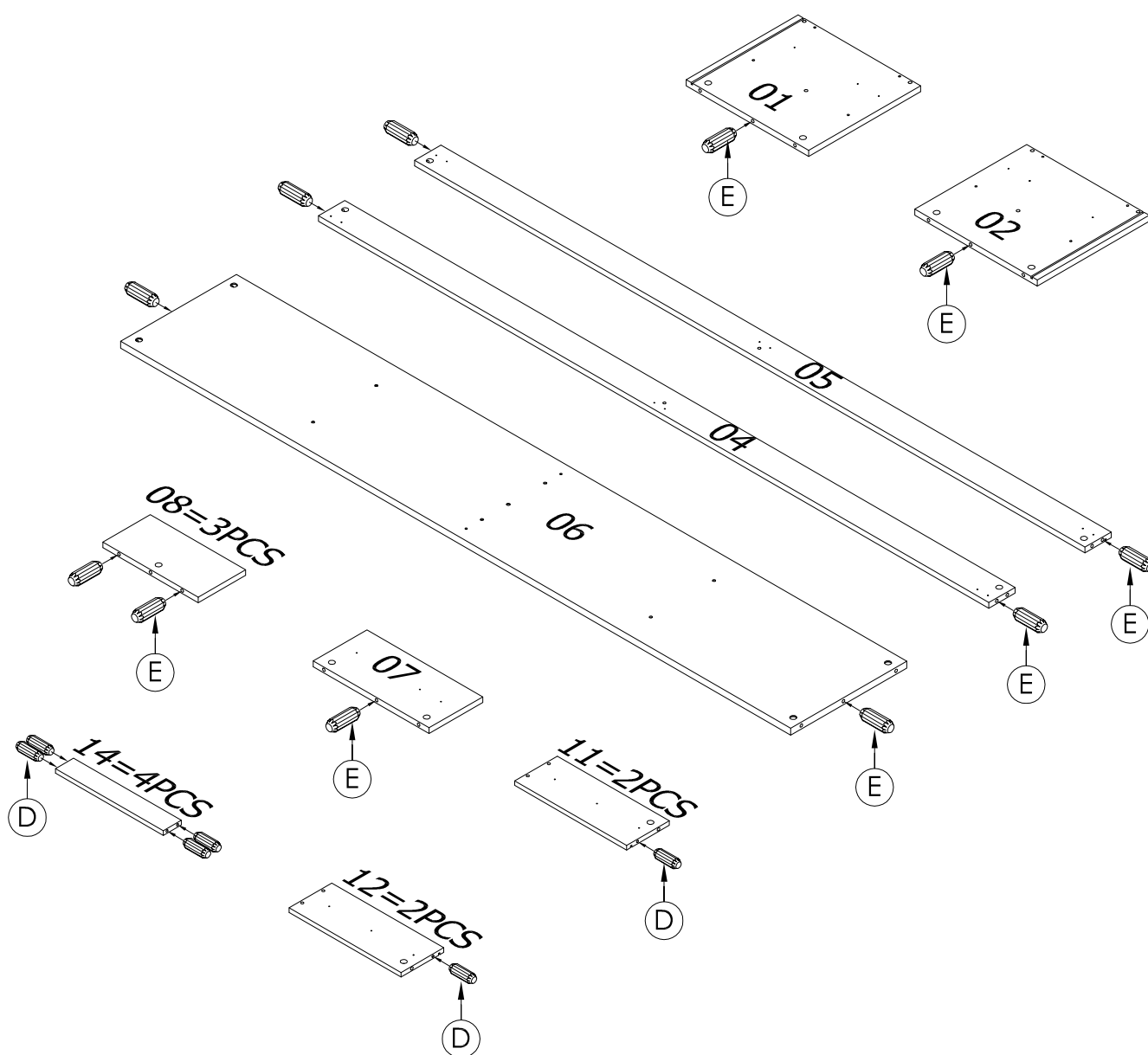
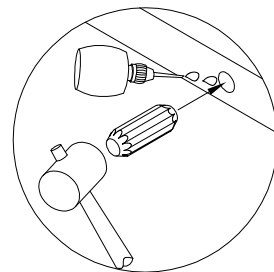

ELARA HIGH GLOSS 2 DRAWER ENTERTAINMENT UNIT

ITEM CODE: 7325-2-01/02

STEP 2

Take panels (1 , 2 , 3 , 6 , 9 & 10) , using a drill on low speed / torque or a phillips head screw driver CAM PINS (F) as shown.

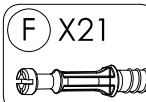
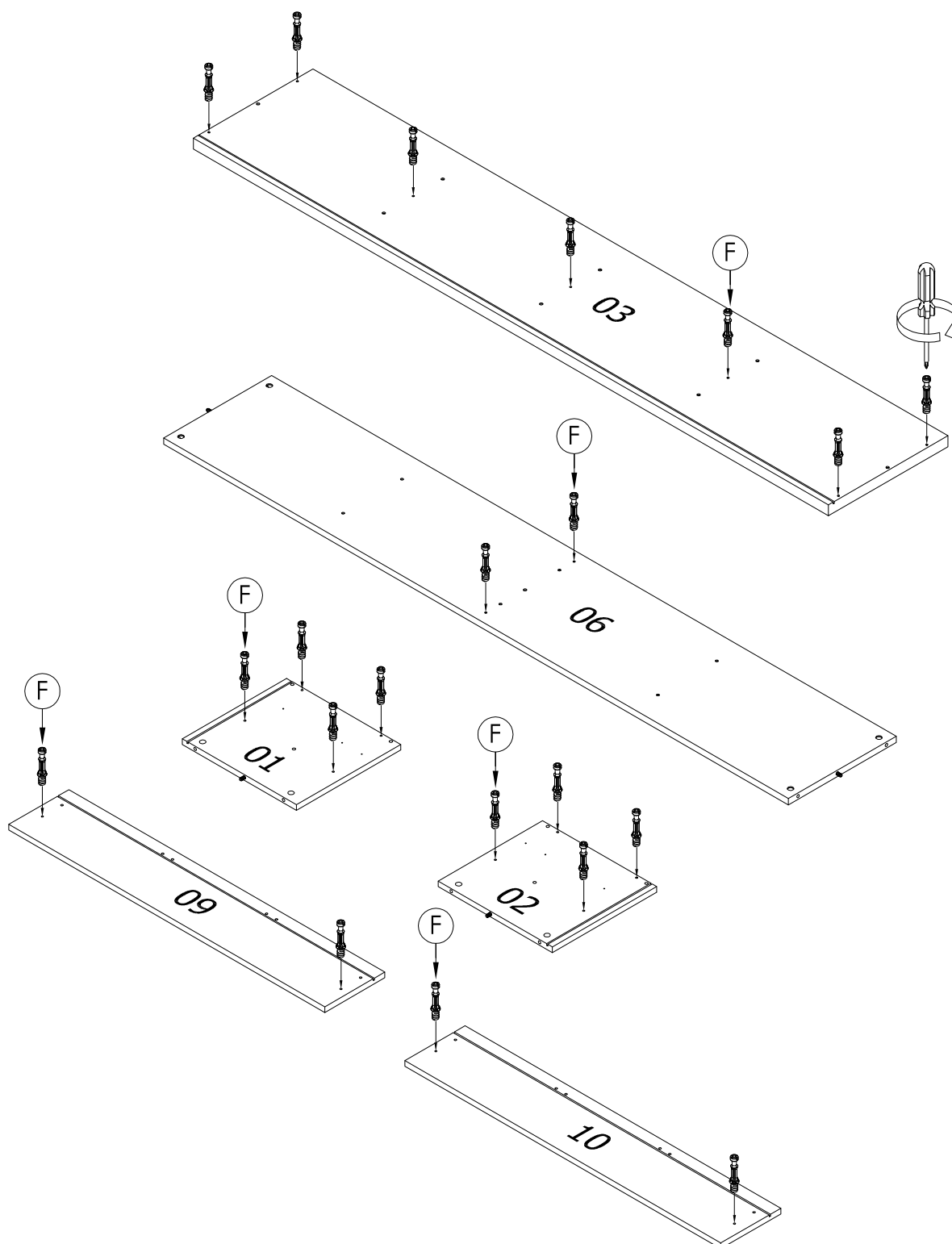

ELARA HIGH GLOSS 2 DRAWER ENTERTAINMENT UNIT

ITEM CODE: 7325-2-01/02

STEP 3

Attach drawer side panels (11 & 12) to drawer back panels (13) using screw 40mm (C) with allen key (L).

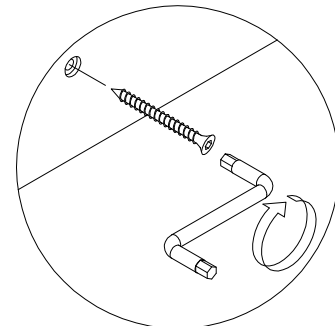
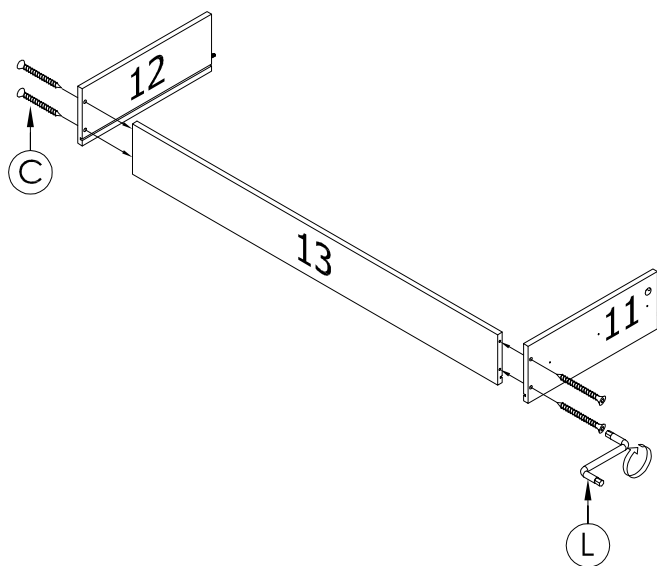

X 2

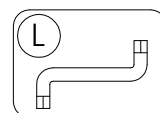
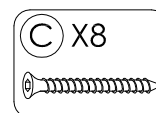

STEP 4

Attach drawer support (14) to drawer frame using glue (N) as shown.

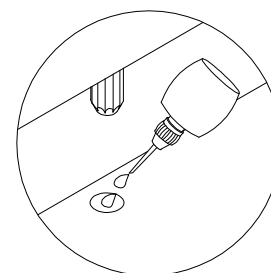
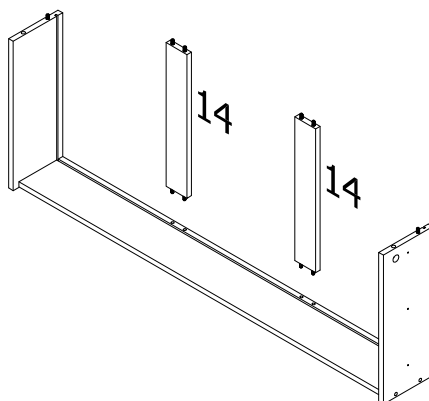

X 2

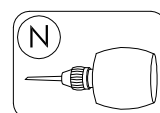

ELARA HIGH GLOSS 2 DRAWER ENTERTAINMENT UNIT

ITEM CODE: 7325-2-01/02

STEP 5

Slot the back panel (15) to drawer frame as shown.

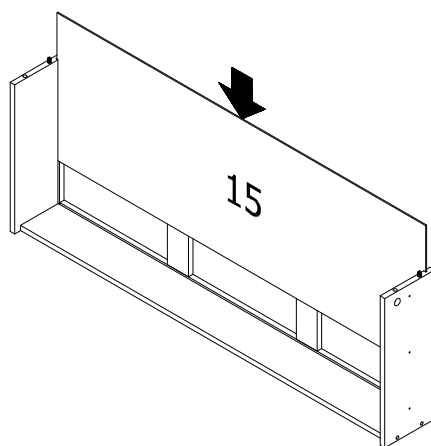

X 2

STEP 6

Attach drawer front panels (9 & 10) to frame as shown using glue (N) and CAM LOCKS (H) as shown.

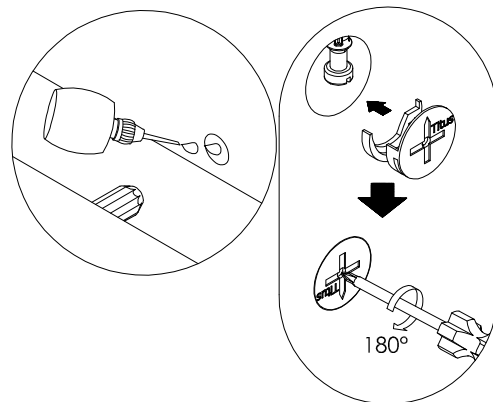
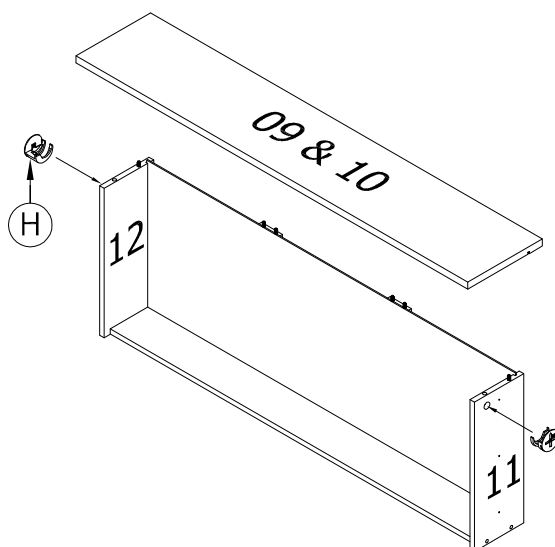

X 2

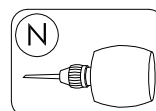
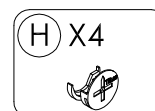

ELARA HIGH GLOSS 2 DRAWER ENTERTAINMENT UNIT

ITEM CODE: 7325-2-01/02

STEP 7

Attach drawer glide insert (Z2) to the drawer side (11 & 12) with 12mm screw (B), ensuring the correct holes as show in diagram.

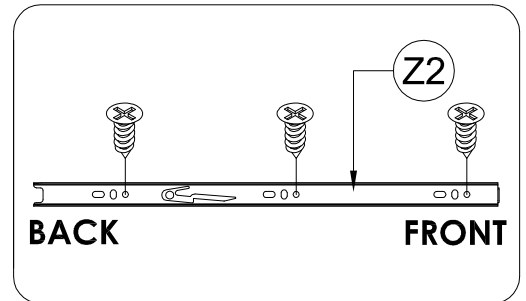
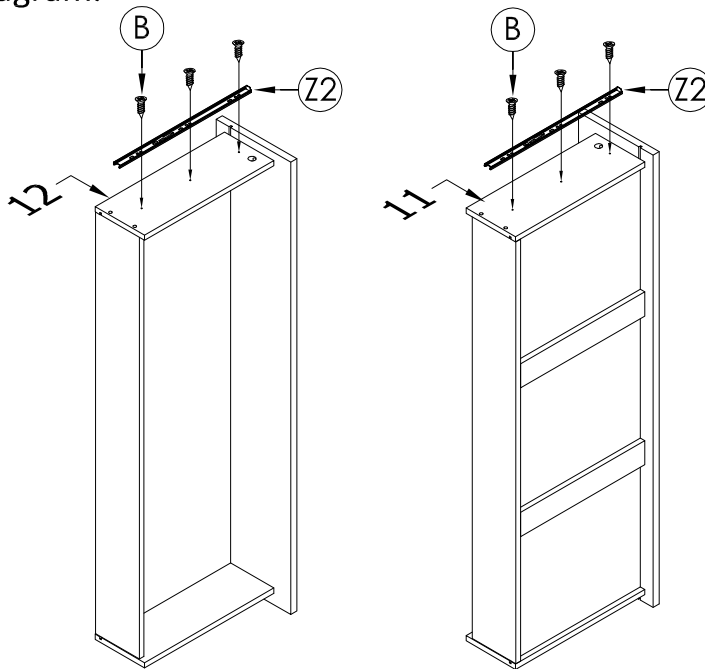

X 2

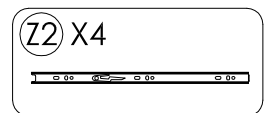
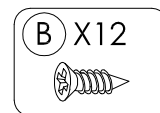

STEP 8

Take both side panel (1 & 2) and support center panel (7), attach metal drawer glide casing (Z1) using 12mm screw (B) as shown.

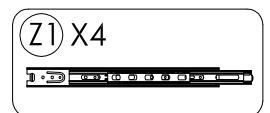
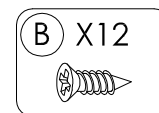
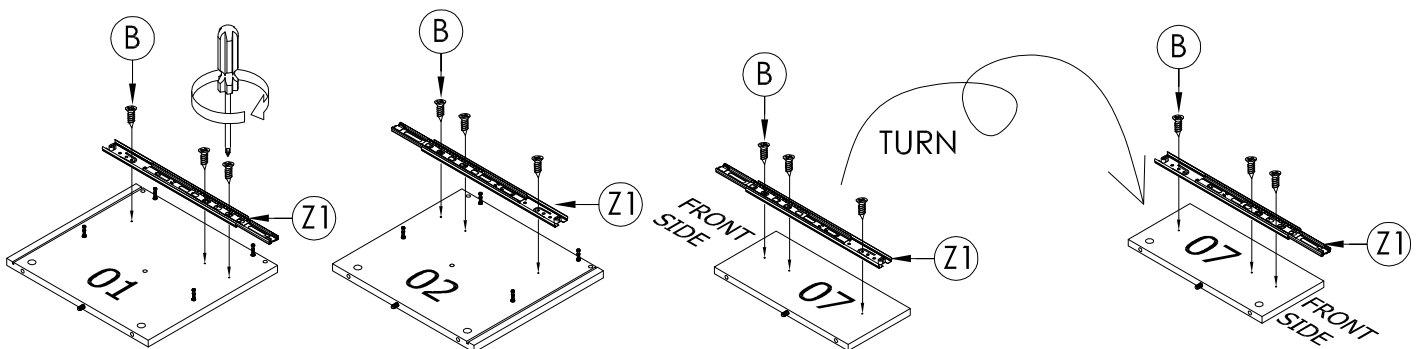
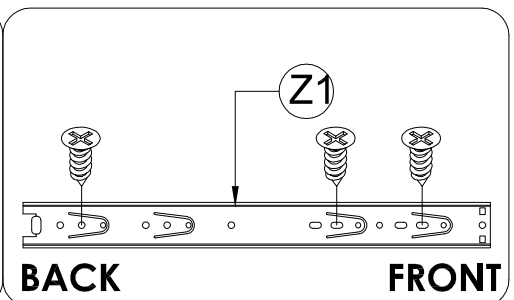
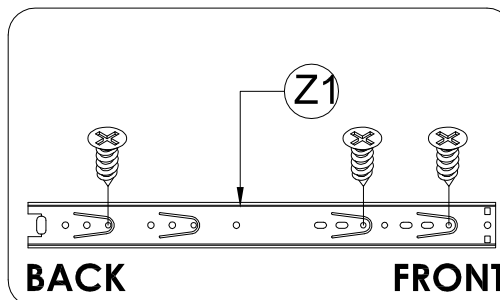

ELARA HIGH GLOSS 2 DRAWER ENTERTAINMENT UNIT

ITEM CODE: 7325-2-01/02

STEP 9

Attach bottom panel (4 & 5) to support center panel (7) using 40mm screw (C) as shown.

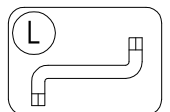
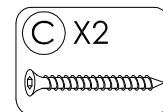
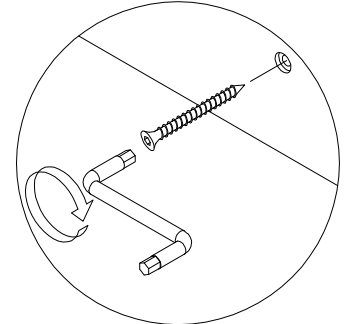
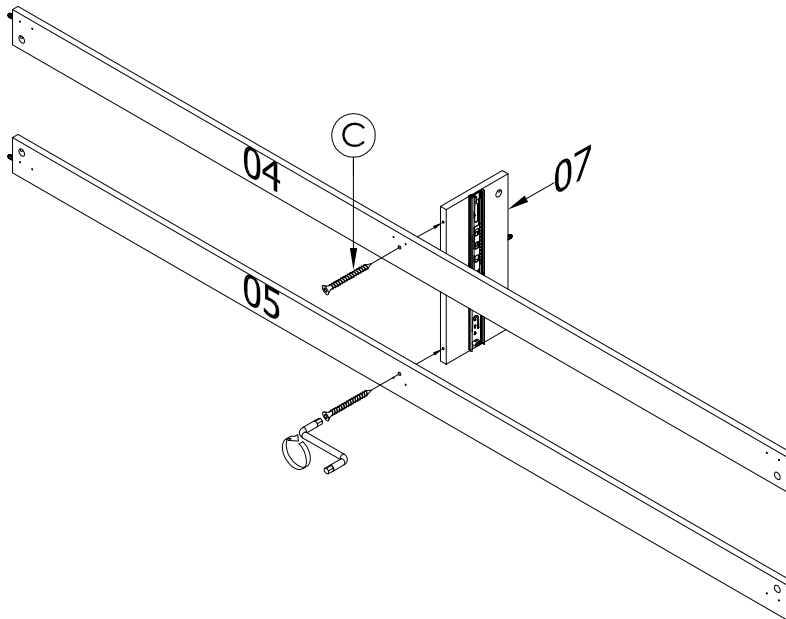

STEP 10

Attach center panel (6) to divider panel (8) using 40mm screw (B) as shown.

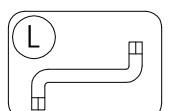
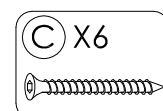
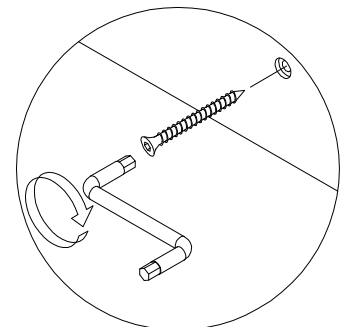
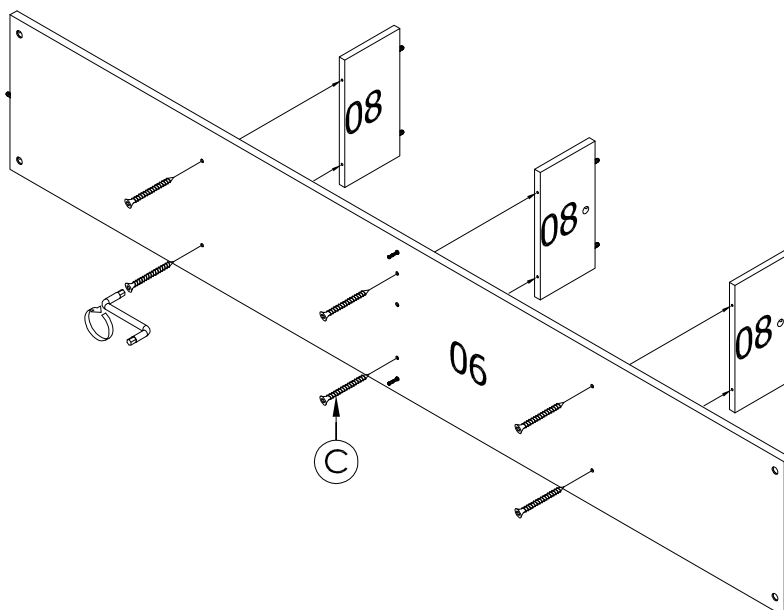

ELARA HIGH GLOSS 2 DRAWER ENTERTAINMENT UNIT

ITEM CODE: 7325-2-01/02

STEP 11

Attach center support panel (7) to center panel (6) using glue (N). Affix CAM BOLT (G) into holes on panel (7).

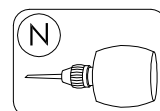
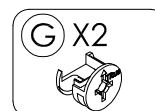
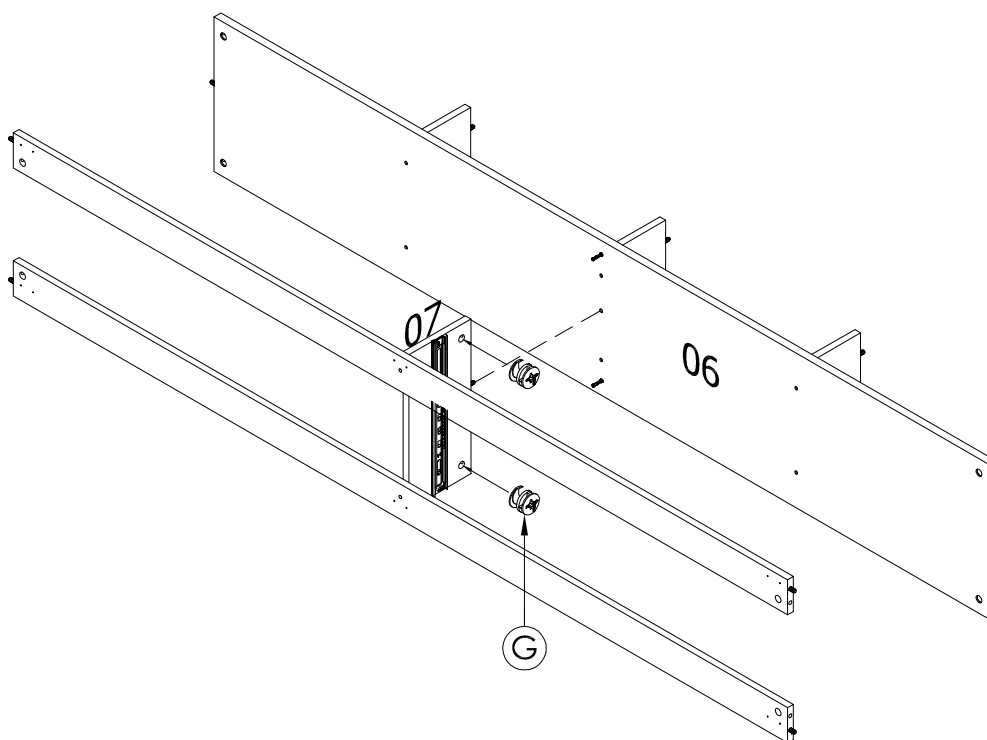
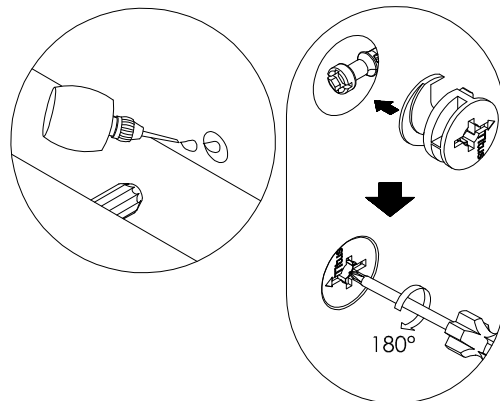

ELARA HIGH GLOSS 2 DRAWER ENTERTAINMENT UNIT

ITEM CODE: 7325-2-01/02

STEP 12

Attach side panel (1 & 2) to frame using glue (N) and CAM LOCK (G) as shown.

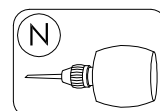
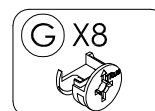
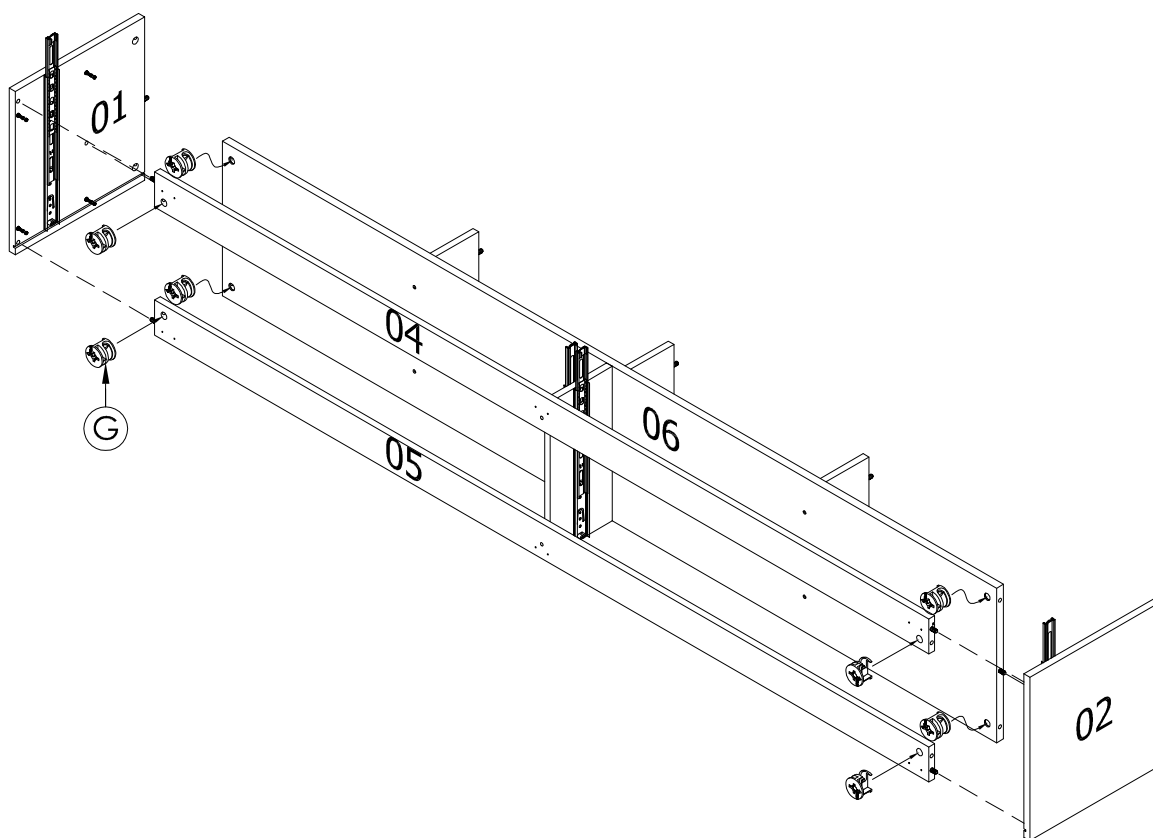
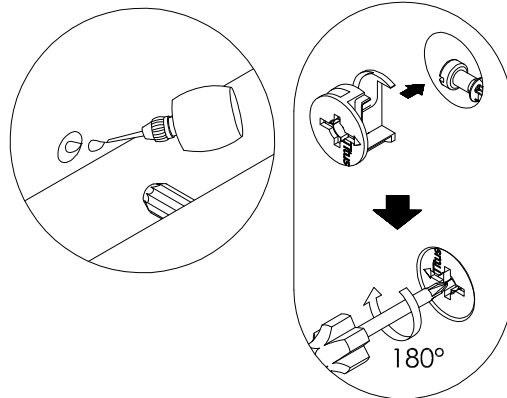

ELARA HIGH GLOSS 2 DRAWER ENTERTAINMENT UNIT

ITEM CODE: 7325-2-01/02

STEP 13

Slot the back panel (16) to frame as shown.

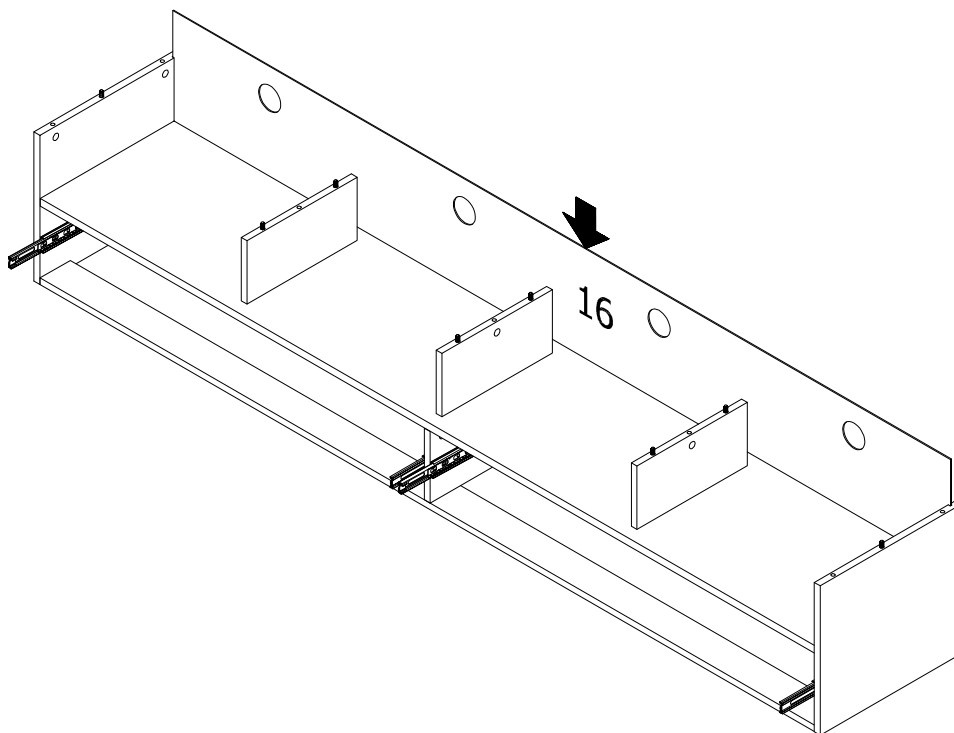

ELARA HIGH GLOSS 2 DRAWER ENTERTAINMENT UNIT

ITEM CODE: 7325-2-01/02

STEP 14

Attach top panels (3) to frame as shown using glue (N) and CAM LOCKS (G) as shown. Then attach plastic cam cap (K) for cover cam hole.

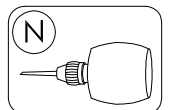
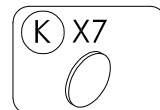
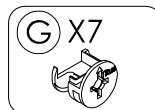
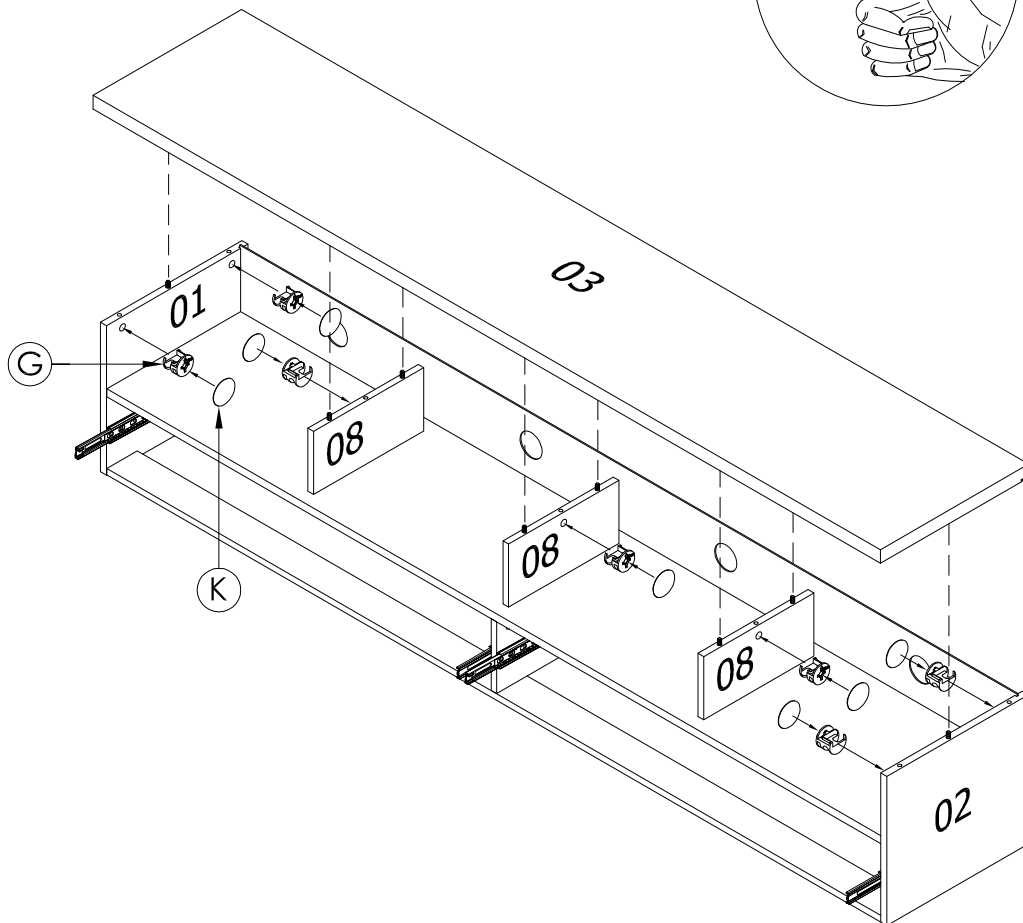
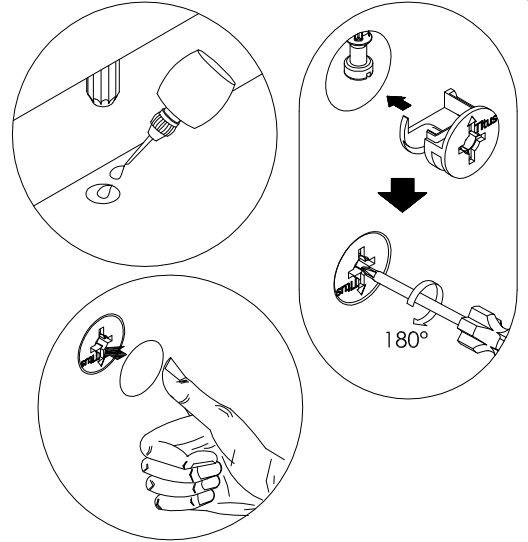

ELARA HIGH GLOSS 2 DRAWER ENTERTAINMENT UNIT

ITEM CODE: 7325-2-01/02

STEP 15

Attach rectangle leg (J) to bottom panels (4 & 5) as shown.

STEP 1

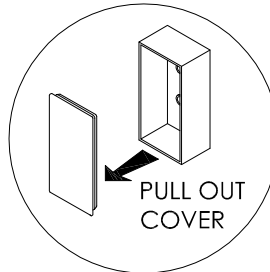

STEP 2

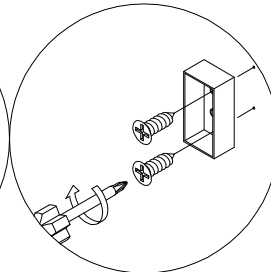

STEP 3

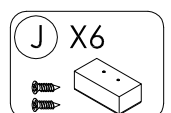
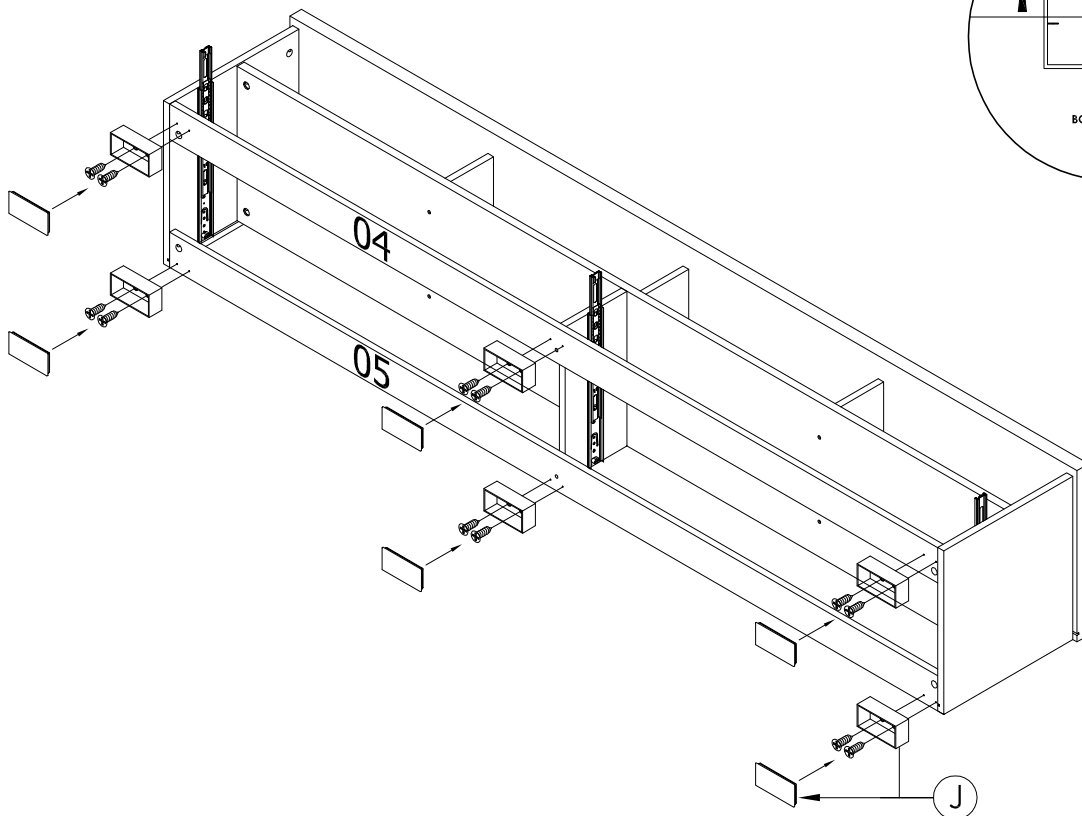
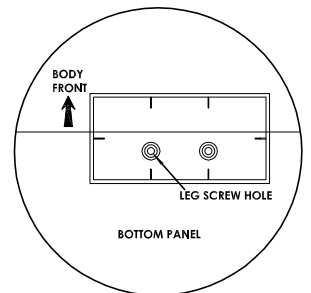
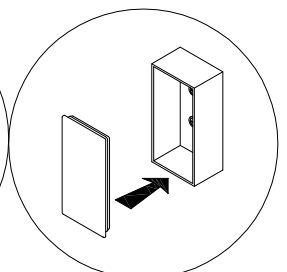

ELARA HIGH GLOSS 2 DRAWER ENTERTAINMENT UNIT

ITEM CODE: 7325-2-01/02

STEP 16

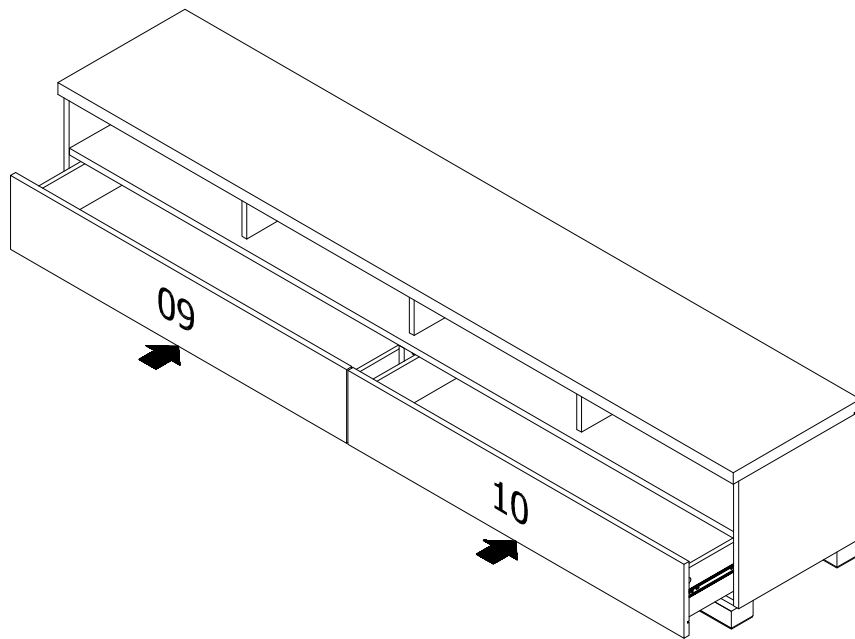

A

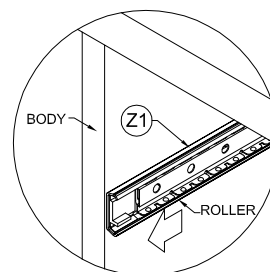
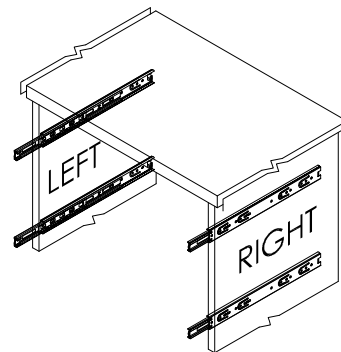

- PUSH THE ROLLER OF Z1 TO THE FRONT SIDE OF THE BODY.

B

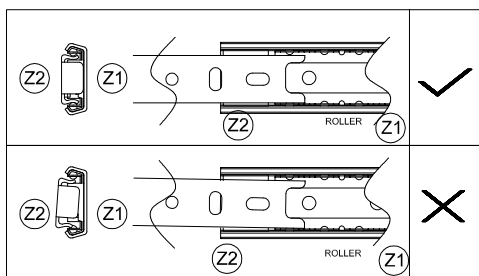
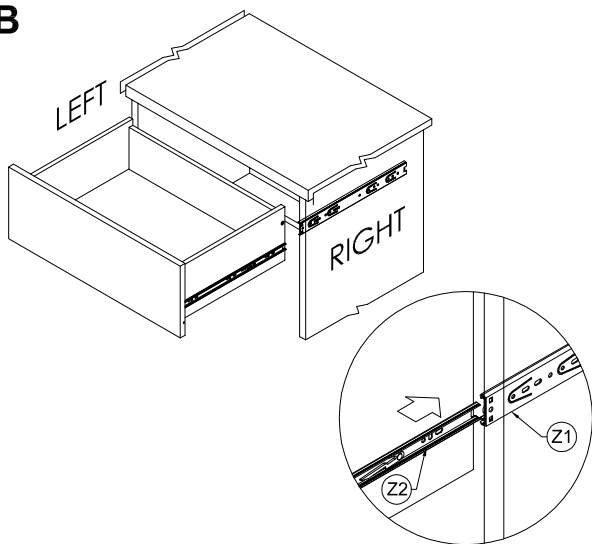

- ALIGN Z2 ON LEFT & RIGHT TO Z1 AT THE CORRECT POSITION.

C

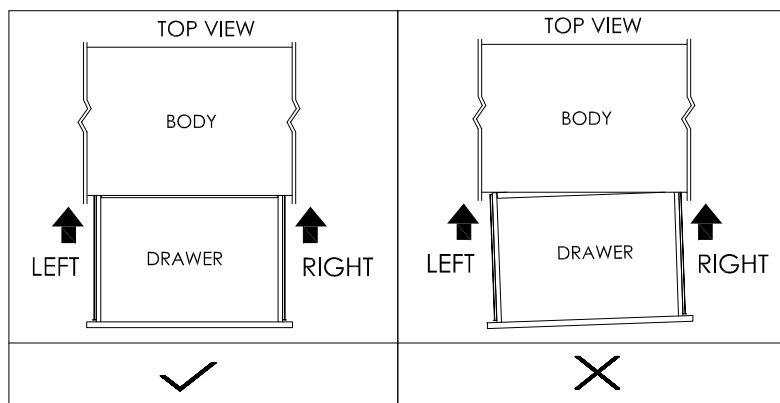

- PUSH IN LEFT & RIGHT SIDE OF THE DRAWER INTO THE BODY SIMULTANEOUSLY.
- WHEN THE DRAWER IS PUSHED IN HALF WAY, THE STOPPER ON Z2 WILL BE ENGAGED INTO Z1. THIS WILL CAUSE THE PUSHING A BIT TIGHT. (PULL OUT THE DRAWER A LITTLE BIT AND SLOWLY PUSH IN THE DRAWER AGAIN TO CHECK WHETHER THE DRAWER IS STUCK / THE DRAWER GLIDE IS INSTALLED CORRECTLY.)
- DO NOT PUSH IN THE DRAWER IF THE DRAWER IS STUCK OR CANNOT BE PUSHED IN SMOOTHLY. TAKE OUT THE DRAWER AND REPEAT STEP 1 & 2.

ELARA HIGH GLOSS 2 DRAWER ENTERTAINMENT UNIT

ITEM CODE: 7325-2-01/02

STEP 17

Attach the backply stoppers (M) to the back panel (16) using 15mm screws (A).

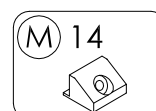
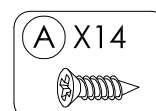
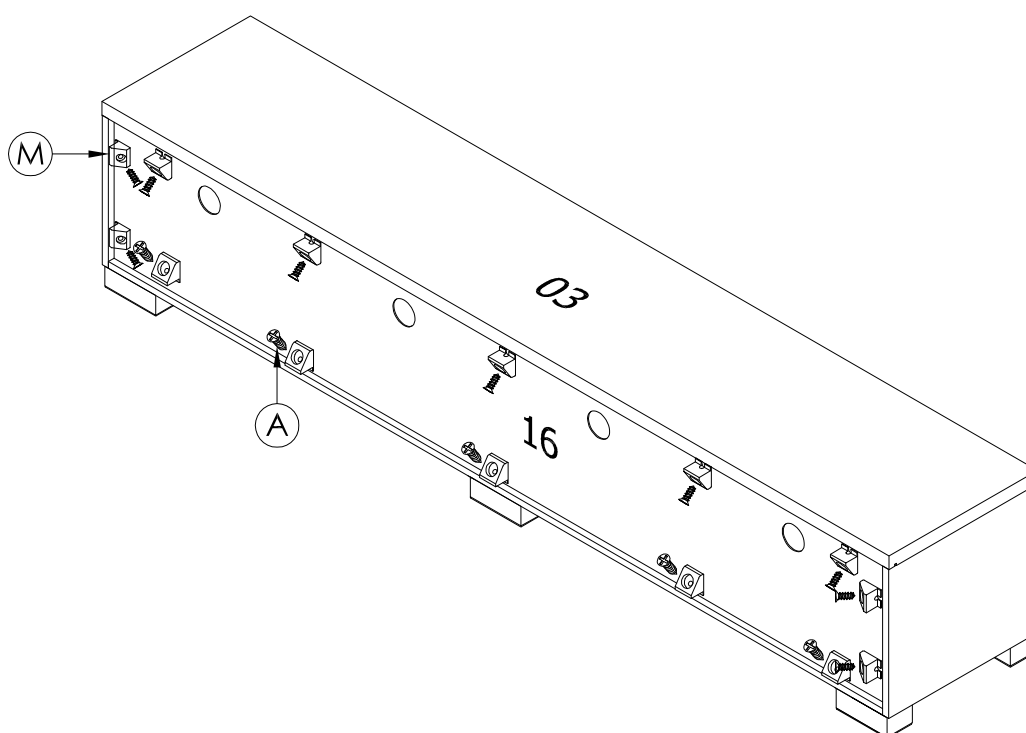
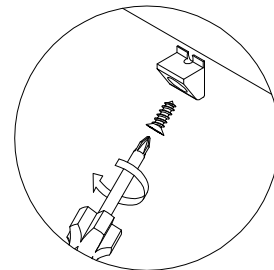

ELARA HIGH GLOSS 2 DRAWER ENTERTAINMENT UNIT

ITEM CODE: 7325-2-01/02

ASSEMBLY IS COMPLETE

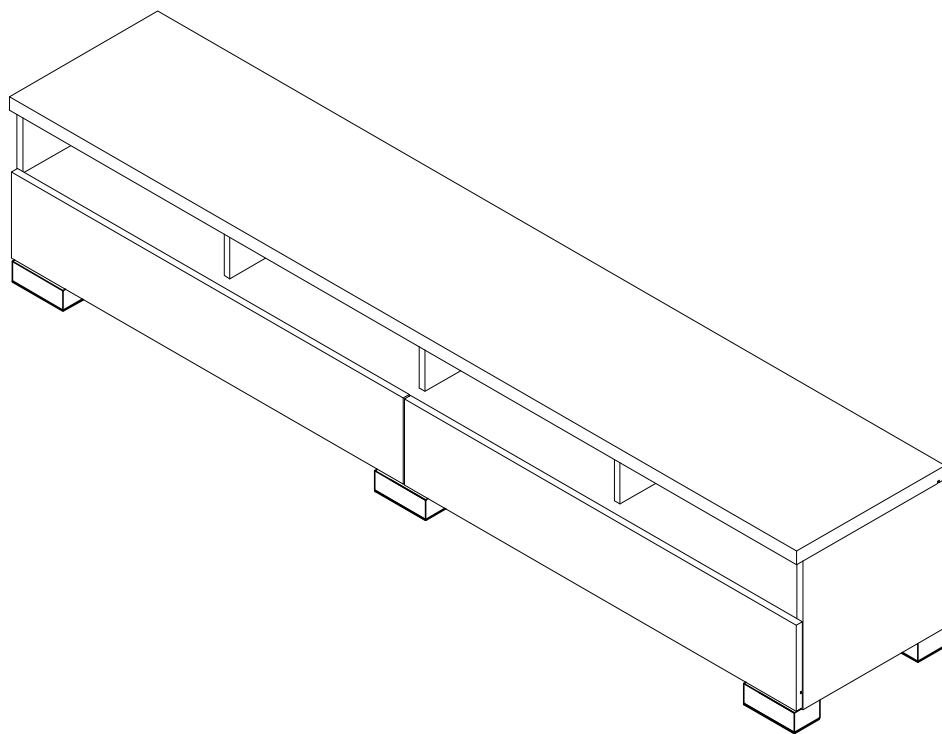



MEUBILAIR
DIRECT IMPORTS

Warranty Certificate

Congratulations! You have made an excellent choice of this quality product. Our commitment to quality also includes our service. Should you, contrary to expectations, experience defects due to manufacturing faults, **Meubilair Direct Imports** will provide you with a warranty against defects as follows:

Warranty

The product is guaranteed to be free from defects in workmanship and parts for a period of 12 months from the date of purchase. Defects that occur within this warranty period, under normal use and care, will be repaired, replaced or refunded at our discretion. The benefits conferred

by this warranty are in addition to all rights and remedies in respect of the product that the consumer has under the Competition and

Consumer Act 2010 and similar state and territory laws.

Our goods come with guarantees that cannot be excluded under the Australian Consumer Law. You are entitled to a replacement or refund for a major failure and for compensation for any other reasonably foreseeable loss or damage. You are also entitled to have the goods repaired or replaced if the goods fail to be of acceptable quality and the failure does not amount to a major failure.

Proof of Purchase

This warranty is valid for the original purchase and is not transferable. Please keep your purchase docket, tax invoice or receipt as the best proof of purchase, and as proof of date on which the purchase was made.

Normal Wear and Tear

This warranty does not cover normal wear and tear to the products or parts.

Exclusions

This warranty does not cover:

- Any defects caused by an accident, misuse, abuse, improper installation or operation, lack of reasonable care, unauthorized modification, loss of parts, tampering or attempted repair by a person not authorized by the distributor.
- Any product that has not been installed, operated or maintained in accordance with the manufacturers' operating instructions provided with the product.
- Any product that has been used for purposes other than domestic use.
- Any damage caused by improper power input or improper cable connection.

MEUBILAIR DIRECT IMPORTS PTY LTD

Customer Service

Email: cs@meubilair.com.au

Address: Unit 4, 4-5 Lambridge Place, Penrith, NSW, 2750

Opening Hours 9:00 am - 4:30pm (Mon-Fri)

When making a return, please ensure the product is properly packaged, so as to ensure that no damage occurs to the product during transit.

Please provide the original or a copy of the proof of purchase. Also please make sure you have included an explanation of the problem.

Please note that the costs of making a warranty claim, including any return postage, will be covered by the supplier identified above.

Please note upon receiving your warranty claim, the supplier will send, via the post or email, a repair and refurbished goods or parts notice.

Please provide your email address and advise the supplier, if you wish to obtain a repair and refurbished goods or parts notice via email.

AFTER SALES SUPPORT

EMAIL : cs@meubilair.com.au

Product code: 7325-2-01/02

04/2017





MEUBILAIR
DIRECT IMPORTS

Warranty Certificate

PRODUCT NAME ELARA HIGH GLOSS 2 DRAWER ENTERTAINMENT UNIT

BRAND NAME

PRODUCT CODE 7325-2-01/02

NAME

ADDRESS

EMAIL

DAYTIME TEL NO

DATE OF PURCHASE

SERIAL NUMBER

We recommend that you attach a photocopy of your receipt, showing the date of purchase, to this Warranty certificate and **keep for your reference**.

In the event of a product fault, please email the Customer Service team. Please ensure that you include the product details (as shown on the card) at hand so that we are able to respond as quickly and efficiently as possible.

MEUBILAIR DIRECT IMPORTS PTY LTD

Customer Service

Email: cs@meubilair.com.au

Address: Unit 4, 4-5 Lambridge Place, Penrith, NSW, 2750

Opening Hours 9:00 am - 4:30pm (Mon-Fri)

AFTER SALES SUPPORT

Product code: 7325-2-01/02

05/2017

